



# SIRCO VM1

Manually operated Transfer Switching Equipment  
from 63 to 125 A

Transfer switches



**SIRCO VM1**  
I-0-II 4-pole 100 A

## The solution for

- > Energy production
- > Critical buildings



## Strong points

- > Safe isolation
- > Modular product

## Conformity to standards

- > IEC 60947-3



## Function

**SIRCO VM1** are 3 or 4 pole modular manual transfer switches with visible breaking. They provide on-load transfer between two sources for any low voltage power circuit, as well as safety isolation. Other applications include source inversion (e.g. to change the direction of a motor) or grounding/earthing.

## Advantages

### Safe isolation

SIRCO VM1 transfer switches enable completely secure isolation owing positive break indication and double visible breaking. The user can view the status of the device either during preventive checks or before working on the system.

### Modular product

SIRCO VM1 transfer switches offer a number of mounting options: DIN rail, back plate or modular panel-mounted.

## Configurations

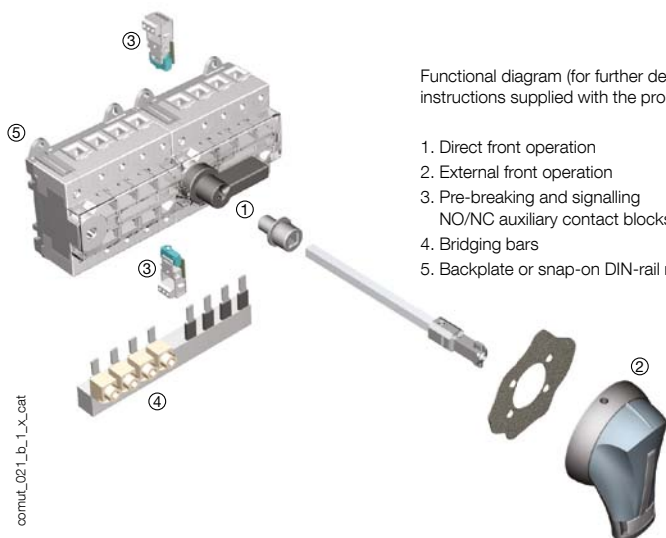

Functional diagram (for further details see the installation instructions supplied with the product).

1. Direct front operation
2. External front operation
3. Pre-breaking and signalling  
NO/NC auxiliary contact blocks
4. Bridging bars
5. Backplate or snap-on DIN-rail mounting.

## References

### VM1 switch I-0-II

Rating (A)	No. of poles	Switch body	Direct handle	External handle	Shaft for external handle	IP20 <sup>(2)</sup> bridging bar	Auxiliary contact
63 A	3 P	4430 <b>3006</b> <sup>(1)</sup>	Black 4439 <b>5012</b>	S1 type Black IP65 1413 <b>2113</b>	200 mm 1402 <b>0820</b> 320 mm 1402 <b>0832</b>	3 P 4499 <b>3006</b> 4 P 4499 <b>4006</b>	1 NO/NC auxiliary contact 4439 <b>0001</b>
	4 P	4430 <b>4006</b> <sup>(1)</sup>					
80 A	3 P	4430 <b>3008</b> <sup>(1)</sup>					
	4 P	4430 <b>4008</b> <sup>(1)</sup>					
100 A	3 P	4430 <b>3010</b> <sup>(1)</sup>					
	4 P	4430 <b>4010</b> <sup>(1)</sup>					
125 A	3 P	4430 <b>3012</b>					
	4 P	4430 <b>4012</b>					

### VM1 switch I - I+II - II

Rating (A)	No. of poles	Switch body	Direct handle	External handle	Shaft for external handle	IP20 <sup>(2)</sup> bridging bars
63 A	3 P	4440 <b>3006</b>	Black 4449 <b>5012</b>	S1 type Black IP65 1413 <b>2114</b>	200 mm 1403 <b>0820</b> 320 mm 1403 <b>0832</b>	3 P 4499 <b>3006</b> 4 P 4499 <b>4006</b>
	4 P	4440 <b>4006</b>				
80 A	3 P	4440 <b>3008</b>				
	4 P	4440 <b>4008</b>				
100 A	3 P	4440 <b>3010</b>				
	4 P	4440 <b>4010</b>				
125 A	3 P	4440 <b>3012</b>				
	4 P	4440 <b>4012</b>				

(1) Device available enclosed (see "Enclosed transfer switches" page 726).

(2) IP: protection index according to IEC 60529.

## Accessories

### Direct operation handle

Rating (A)	Switching type	Reference
63 ... 125	I - 0 - II	4439 <b>5012</b>
63 ... 125	I - I+II - II	4449 <b>5012</b>



access\_111\_a\_1\_cat

### External operation handle

#### Use

Door interlocked external front operation handles include an escutcheon, are padlockable and must be utilised with an extension shaft.

Rating (A)	Switching type	Padlockable	External IP <sup>(1)</sup>	Reference
63 ... 125	I - 0 - II	1 position	IP55	1411 <b>2113</b>
63 ... 125	I - 0 - II	1 position	IP65	1413 <b>2113</b>
63 ... 125	I - 0 - II	3 positions	IP65	1413 <b>2813</b>
63 ... 125	I - I+II - II	1 position	IP65	1413 <b>2114</b>
63 ... 125	I - I+II - II	3 positions	IP65	1413 <b>2814</b>

(1) IP: protection index according to IEC 60529.



access\_149\_a\_2\_cat

### Type S handle adapter

#### Use

Enables S-type handles to be fitted in place of existing older style SOCOMEC handles. Adapter can also be utilised as a spacer to increase the distance between the panel door and the handle lever. Dimensions: adds 12 mm to the depth of the handle.

Colour	To be ordered in multiples of	External IP <sup>(1)</sup>	References
Black	1	IP65	1493 <b>0000</b>

(1) IP: protection index according to IEC 60529.



access\_187\_a\_2\_cat

### Alternative S-type handle covers

Colour	To be ordered in multiples of	Reference
Light grey	50	1401 <b>0001</b>
Dark grey	50	1401 <b>0011</b>

#### Use

For single lever type S1 handles. Other colours available: consult us.



access\_198\_a\_1\_cat

# SIRCO VM1

Manually operated Transfer Switching Equipment  
from 63 to 125 A

## Accessories (continued)

### Shaft for external operation

#### Use

Standard lengths:

- 200 mm,
- 320 mm.

Other lengths available: consult us.

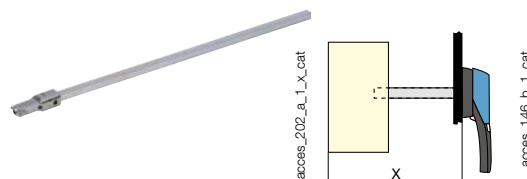

SIRCO VM1 I - 0 - II			
Rating (A)	Side X (mm)	Shaft length (mm)	Reference
63 ... 125	128 ... 290	200 mm	1402 0820
63 ... 125	128 ... 410	320 mm	1402 0832

SIRCO VM1 I - I+II - II			
Rating (A)	Side X (mm)	Shaft length (mm)	Reference
63 ... 125	128 ... 290	200 mm	1403 0820
63 ... 125	128 ... 410	320 mm	1403 0832

### IP20 bridging bar

#### Use

For creating a common connection between switches I & II, on the top or bottom side of the SIRCO VM1, to enable, for example, the load to be fed from either incoming source (I or II).

The bridging bar does not reduce the connection capacity of the cage clamp terminals.

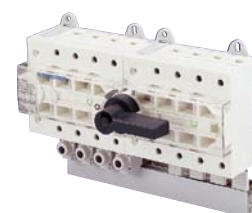

Rating (A)	No. of poles	Reference
63 ... 125	3 P	4499 3006
63 ... 125	4 P	4499 4006

### NO/NC auxiliary contact

#### Use

Pre-breaking and signalling of positions I and II: 1 NO/NC auxiliary contact for each position.

#### Characteristics

- Snaps on and is secured by a screw.
- Connector block with a maximum capacity of up to 2 x 1.5 mm<sup>2</sup> per terminal.

Rating (A)	Switching type	Contact(s)	Reference
63 ... 125	I - 0 - II	1	4439 0001 <sup>(1)</sup>

(1) Not available for overlapping contact switch (I-I+II-II).

## Enclosed solutions

### General characteristics



- Operating handle: S-type padlockable black handle.
- Protection degree: IP54 / IK 09.
- Colour: RAL 7035
- Closing plates: top and bottom.
- Material: 1.5 mm thick XC steel.
- Coating: epoxy polyester powder.
- Wall mounting: 4 mounting brackets supplied (not fitted).
- Door: solid with hinges.
- Locking device: 3 mm double bar key (key supplied).
- Miscellaneous: 2 earth connection bolts, double door locking.

### References

Rating (A)	No. of poles	Top/bottom connection Reference
63 A	3 P	4413 3006
	4 P	4413 4006
80 A	3 P	4413 3008
	4 P	4413 4008
100 A	3 P	4413 3010
	4 P	4413 4010

### Dimensions

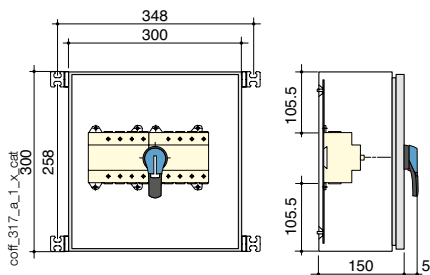

Rating (A)	Max. connection cross-section (mm <sup>2</sup> )	Weight (kg)
3 x 63 / 4 x 63	50	9
3 x 80 / 4 x 80	50	9
3 x 100 / 4 x 100	50	9

